

What It's All About!

The Private Industry Council and its Education and Technology Institute are committed to connecting businesses and individuals in this region with essential resources. As part of this effort, we are pleased to provide the corporate training center at our headquarters office in Greensburg.



Situated in the picturesque Westmoreland countryside, our facilities offer a serene atmosphere for meeting or learning.

Our attractive classrooms and computer labs can be adapted to meet your needs. Audio-visual equipment and technical support are also available. Our telecommunications center is particularly valuable in a technologically advanced world.



Call us today at 724-836-2600 or 724-836-2395 to discuss your specific needs or to schedule a visit.



"Where needs are met...goals are reached."

We are dedicated to building tomorrow's workforce in southwestern Pennsylvania, and part of the way we do this is by providing assistance to employers to meet their workforce needs.

Whether we are matching an employer with a skilled worker to fill a job opening or are working with regional employers to deliver needed resources to thrive in a competitive economy, we are here to help.

For additional information, contact:

Private Industry Council of Westmoreland/Fayette, Inc.

219 Donohoe Road, Greensburg, PA

(724) 836-2600

E-mail: info@privateindustrycouncil.com

www.privateindustrycouncil.com

www.facebook.com/privateindustrycouncil

Education and Technology Institute

219 Donohoe Road, Greensburg, PA

(724) 836-2395

E-mail: admissions@eti.edu

www.eti.edu

www.facebook.com/eti.edu

Corporate Training Center

Meet, train, and educate at a place in your own backyard—
here in Westmoreland County.



Private
Industry
Council
OF WESTMORELAND/FAYETTE, INC.

219 Donohoe Road
Greensburg, PA

**Education
and
Technology
Institute**

Floor Plan—Classrooms and Computer Labs

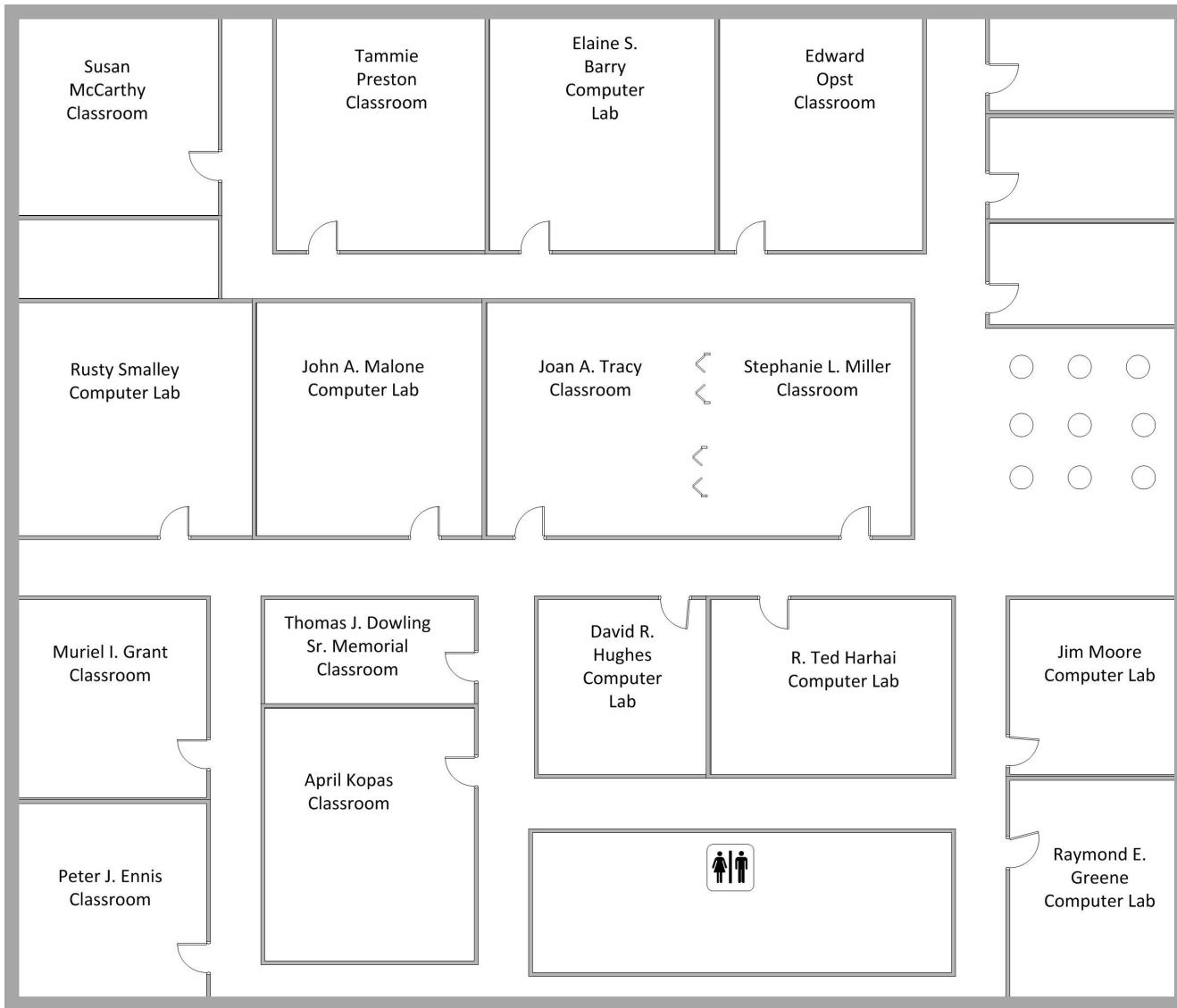

Note: Drawing is an approximation and not to scale.

Our facilities include:

- ◆ Training and meeting space in a tiered-seating arrangement in the April Kopas Classroom.
- ◆ Computer labs that accommodate up to 20 people.
- ◆ Versatile traditional classroom seating for 50+.
- ◆ Ample free and convenient parking.

Our telecommunications equipment provides:

- ◆ Ability to view and record DISH Network™ exclusive channels for educational, training, and business-related programming.
- ◆ Access to webinars, satellite broadcasts, and distance learning opportunities.
- ◆ 8 ft by 8 ft drop screen for comfortable viewing.

Room Configurations



Our corporate training center includes a variety of room sizes and configurations. Rooms can be set up to accommodate additional seating or your specific needs. The table below shows the number of computers and table seats that are available in each standard room setup.

	Computers	Table Seats
Rusty Smalley Computer Lab/Classroom	18	10
R. Ted Harhai Computer Lab	18	-
David R. Hughes Computer Lab	12	-
John A. Malone Computer Lab	20	-
Raymond E. Greene Computer Lab	12	-
Peter J. Ennis Computer Lab/Classroom	6	18
Stephanie L. Miller Classroom	-	24
Joan A. Tracy Classroom	-	24

New Classrooms

Edward Opst Classroom	-	16
Elaine S. Barry Computer Lab	18	-
Tammie Preston Classroom	-	14
Susan McCarthy Classroom	-	14